

## CRUISING GUIDE

### Thank you for choosing to travel with Murray Princess.

Your travel is subject to the terms and conditions of the Passenger Cruise Contract. For your convenience, the Murray Princess Cruising Guide provides the following:

- Check-in Information
- Cruising Information
- Guidelines for Limited Mobility and Fitness for Travel
- Adelaide Coach Transfer Map
- Adelaide to Mannum Directions
- Murray Princess Deck Plan
- Murray Princess Accommodation
- Medical Emergencies and Services
- Optional Onshore Tours

Once the vessel departs, we are unable to obtain additional supplies or medicines. Special requests or dietary requirements must be advised together with your Passenger Cruise Contract when your deposit is paid or within 48 hours of full payment when booking online. Upon boarding, please consult with your Guest Services Attendant and also ensure you bring any prescription medication you may need.

*Within this "Cruising Guide", "Company" refers to Murray Princess and the SeaLink Travel Group, its servants and agents and "the passenger" refers to the passenger booked to travel.*

### CHECK-IN INFORMATION

The following information is required at check-in:

- Photo Identification for each passenger (drivers licence or passport)
- Your Murray Princess Travel Document

### CRUISING INFORMATION

#### ACCOMMODATION

60 cabins including inside cabins, outside cabins and staterooms each with their own private ensuite, electric blankets, soaps, shampoo, hairdryer and towels. Each cabin is serviced daily and is approximately 12 square metres.

#### ALCOHOL

Our licencing laws do not permit alcohol to be brought on-board the vessel by passengers. Bottles of wine purchased from the wineries visited are allowed to be brought back on the vessel but are not to be consumed whilst on board the cruise.

#### BAGGAGE

Baggage is limited to what you can stow in your cabins so you would be advised not to over pack. All bags must be clearly labelled with your name and cabin number. Bags have to be handled by crew and we would appreciate a weight limit of 15 kilograms per bag.

#### BAR

Normal closing time for bar services is midnight.

#### BIRTHDAYS AND SPECIAL OCCASIONS

You may want to order a cake, sparkling wine or make some other celebratory arrangement for that special occasion. Orders need to be given 14 days prior to sailing to ensure we can accommodate your request. Pre-payment is required.

#### BOARDING

The Murray Princess departs from Mary Ann Reserve, Mannum selected Fridays and Mondays at 4.30pm with boarding commencing from 2.30pm. Please ensure you are at the vessel no later than 4.00pm. These times apply for all cruises unless otherwise stated.

#### CAR PARKING

Complimentary car parking is available at Mannum and is subject to availability, pre-bookings are essential by calling the Murray Princess Mannum Operations Team on (08) 8569 2511. Your Travel Document will include your car parking details if arrangements have been made. Park your vehicle in the car parking in front of the Murray Princess; after you have checked-in and your luggage has been stowed on the vessel, our crew will direct you to the parking facilities. Please note every care will be taken but parking is at the passenger's own risk.

Please Note: We are unable to accommodate caravans or motorhomes in our parking facilities. Please contact the Mannum Caravan Park on (08) 8569 1402 to make a booking.

#### COFFEE AND TEA

Complimentary coffee and tea is available in the Paddlewheel Lounge. Espresso coffee is also available for purchase from the Sturt Bar and Paddlewheel Cafe.

#### DINING

Dining aboard the Murray Princess includes delicious table d'hôte and a la carte menus, plus a special campfire barbecue (weather permitting; seven and four night cruises only). There is one sitting for all meals onboard.

## **DISEMBARKATION**

Please leave your labelled luggage outside your cabin door prior to breakfast on the final day and your cabin key in the outside of the door. Luggage will be taken ashore by the crew. All cabin accounts must be settled the evening prior to disembarkation.

## **DRESS**

During the day, sportswear and casual clothing is suggested. We kindly ask that you do not wear bathing suits, singlets or brief attire in public rooms and lounges, especially in the dining room. Footwear is requested in both the dining room and lounges at all times. During the evening, smart casual wear is recommended – an open neck shirt and trousers for gentlemen and a dress, skirt or pants and blouse for the ladies. On the final night of the cruise, a jacket and tie would not be out of place for gentlemen and a cocktail dress or pants outfit for the ladies. Be sure to bring a sun visor or hat, sunglasses and good sun block/sun screen. Sandals, low-heeled deck shoes and tennis shoes are most suitable on-deck and for onshore excursions.

## **DRINKING WATER**

The water from your cabin tap is not suitable for drinking. Spring water is supplied in your cabin – please feel free to refill the container from the water tap available in the Paddlewheel Lounge.

## **ELECTRICS**

The vessels electricity is AC 240 volts, 50 cycle (standard electrical power used in Australia). A hairdryer is provided in your cabin. You are welcome to bring your own shavers and mobile phone chargers.

## **FACILITIES**

A gym, sun deck, bar, two lounges, single-sitting dining room, tender boat, gift shop, café, library, lift (Randell, Cadell and Sturt Decks only) and guest laundry are available for you to use.

## **GIFT SHOP/CAFE**

The Gift Shop is located on the Randell Deck within the Paddlewheel Lounge and contains a selection of souvenirs, toiletries and hats. Espresso coffee is also available for purchase. Opening times are announced daily.

## **GRATUITIES**

Tipping is always a personal choice. As a general guide, tipping is not required but is always gratefully received.

## **GYM**

A small gym with exercise equipment is located on the Chaffey Deck. Passengers under the age of 16 years are not permitted to use the equipment without a supervising adult. Use of the equipment is at the passenger's own risk.

## **INCLUSIONS**

The following is included in your cruise: all meals, guided nature walks, eco-excursions, onboard presentations, live entertainment, sun deck, two lounges, restaurant and mini gymnasium. Complimentary return coach transfers are available to and from selected Adelaide CBD hotels or return to the Adelaide Airport or secure car parking in Mannum. Fares exclude drinks, optional tours and additional services.

## **LAUNDRY**

A washing machine, clothes dryer and ironing board are available for you to use in the vessel's laundry located on the Chaffey Deck. Washing powder can be purchased on-board. The laundry is available from 7.00am to 3.00pm each day. If you wish to use the laundry facilities, please make your booking at the Paddlewheel Cafe.

## **LIBRARY**

A selection of books are available for your reading pleasure in the upper level of the Paddlewheel Lounge. Kindly return or swap the books so that others can also enjoy them and ensure books are returned upon departure.

## **LIFT**

The lift operates between the Sturt, Cadell and Randell Decks and is located at the aft end (rear) of the vessel. The following public rooms are situated on decks without lift access: Chaffey Deck - laundry and gym (accessible by stairwells only); sun deck - (accessible by a steep, shallow set of stairs only).

## **MEDICAL**

There is no doctor or pharmacy on-board the vessel, however our Officers are trained in First Aid. Please ensure you bring any prescription medicines you may require. For further information please refer to the Medical Emergencies and Services document.

## **MEDICAL (FITNESS TO TRAVEL)**

Each passenger warrants that they are physically fit and capable of undertaking the cruise. A certificate of fitness to travel by your doctor is required for passengers over 80 years of age and/or passengers with limited mobility and a copy must be produced prior to travel. For full details, please refer to Section 9 in the Passenger Cruise Contract and the Guidelines for Limited Mobility and Fitness to Travel information.

## **MOBILE TELEPHONES/CELL PHONES**

Mobile telephone coverage can be irregular along the river.

## **ON-BOARD PURCHASES**

For your convenience, we operate an on-board account for each cabin for the duration of your cruise. You may use your cruise account for on-board drinks, souvenirs and some optional onshore tours. Your cruise account must be settled the night prior to disembarkation. AUD\$ cash or credit card (Visa and MasterCard) will be accepted for payment of your account, however we advise personal cheques cannot be accepted. It is advisable for you to bring some cash for onboard activities and onshore excursions.

## **ONSHORE TOURS**

During the cruise, a number of onshore tours are available (charges may apply to some optional tours). You may also be requested to book your preferred times for excursions. As a courtesy to your fellow passengers, please be prompt to your marshalling station with any items you may need including sunglasses, camera, sunscreen, hat or walking shoes. Details of the marshalling station and times will be provided in your daily on-board itinerary. You are welcome to stay on-board the vessel if you do not wish to participate in excursions.

## PASSENGER CRUISE CONTRACT

Your travel is subject to the terms and conditions of the Passengers Cruise Contract. **Your completed Passenger Cruise Contract must be returned with your deposit or within 48 hours of full payment when booking online.**

## SMOKING

Please be advised that the sun deck, all cabins and public rooms are non-smoking. Smoking is permitted in designated areas of the outside decks only. As a courtesy to your fellow passengers, please refrain from smoking pipes and cigars. Cigarettes are not sold on-board.

## SPECIAL DIETS

Passengers requiring special meals should advise the Company by completing the **Special Dietary and Allergy Information Form**. This should be returned together with your Passenger Cruise Contract when your deposit is paid or within 48 hours of full payment when booking online. It is also recommended that you confirm your dietary requirements with the Guest Services Attendant when boarding. Where possible, we will endeavour to meet your requests. As a guide we regularly cater for gluten free, dairy free, vegetarian, diabetic and non-seafood requirements.

## SWIMMING

If you wish to swim in the river, please seek advice from one of our crew as to the easiest and safest method of doing so.

## TOWELS

Help us save water and the environment. If you would like your towel washed and replaced, please ensure it is left on the bathroom floor for collection. If towels are not required to be washed and replaced, they are to be placed on the bathroom towel rack to allow them to dry for re-use.

## TRANSFERS FROM/TO ADELAIDE

### COACH TRANSFERS

Complimentary coach transfers are available between Adelaide and Mannum (approx. 90 minutes travel from Adelaide to Mannum) and are subject to availability – pre-bookings are essential.

Adelaide Coach Transfers depart and return from the following CBD locations:

- **Adelaide Central Bus Station:** 85 Franklin Street, Adelaide
- **Hilton Adelaide:** 233 Victoria Square, Adelaide
- **Majestic Roof Garden Hotel:** 55 Frome Street, Adelaide
- **Crowne Plaza Adelaide:** 27 Frome St, Adelaide
- **Stamford Plaza Adelaide:** 150 North Terrace, Adelaide
- **The Terrace Hotel Adelaide:** 208 South Terrace, Adelaide

The return arrival time to Adelaide on Monday and Friday is approximately 11am to 11.30am and an option to be transferred to Adelaide Airport is available – pre-bookings are essential.

## PRIVATE CAR TRANSFERS

Private transfers are available to/from the Adelaide CBD as well as a return to Adelaide Airport. Additional charges apply and pre-bookings are essential.

Your Travel Document will include your coach or private transfer details if arrangements have been made. Please check your Travel Document or Itinerary for full information.

## TURNDOWN

Each evening while you are dining we will provide a turndown service and leave a copy of the following day's itinerary.

## URGENT TELEPHONE MESSAGES

Urgent messages or emergency information can be transmitted to the vessel by contacting our Mannum Operations Department, telephone +61 8 8569 2511.

## VALUABLES

For your convenience, valuables may be lodged with the Captain for safe keeping in the Captain's safe. The Company accepts no liability for loss or damage.

## WEATHER

Rain or shine, waters on the Murray always make for smooth sailing. As a guide, expected seasonal temperatures range from 16-35 degrees Celsius during summer and 6-17 degrees Celsius during winter.

## WHEELHOUSE

You are welcome to visit the wheelhouse, however please avoid times when the vessel is manoeuvring into or leaving port. Wheelhouse tours are conducted during the voyage. Please see the Guest Services Attendant for details.

## WI-FI

Free Wi-Fi is available in most areas of the vessel. Coverage may vary along the river. Please ask our crew for details.



**The Captain, crew and employees of Murray Princess wish you a fantastic cruise.**

**PHONE 1300 729 938 OR VISIT MURRAYPRINCESS.COM.AU**



## GUIDELINES FOR LIMITED MOBILITY & FITNESS TO TRAVEL

### FITNESS TO TRAVEL

A certificate of Fitness to Travel is required from all passengers 80 years of age and over and a copy must be produced 30 to 60 days prior to travel. If passengers have pre-purchased Travel Insurance which covers medical expenses, a Doctor's Certificate is not required however a copy of the Travel Insurance certificate must be produced 30 to 60 days prior to travel. For bookings made within 30 days of travel, a copy of your certificate of Fitness to Travel or Travel Insurance certificate must be produced no later than 48 hours prior to travel.

All Passengers: The Carrier reserves the right to refuse passage to a passenger, or to disembark a passenger, who has failed to give proper notice of physical disability, illness or handicap requiring special care, attention or treatment or who in the Carrier's opinion is physically or mentally unfit for travel. The Carrier in its sole discretion may require the production of a Doctor's Certificate in this regard. Please refer to Clause 9 of the Passenger Cruise Contract.

### BOARDING MURRAY PRINCESS

Access to Murray Princess whilst at Mannum is via Mary Ann Reserve, across approximately 100 metres of grassed parkland. Boarding is via a gangway onto Randell Deck. The gangway is of suitable width for wheelchair use.

### GETTING AROUND THE MURRAY PRINCESS

The Murray Princess has five passenger decks. All decks are accessible by stairwells of approximately 10 to 14 steps. A lift services three decks – Randell, Cadell and Sturt Decks.

### PUBLIC ROOMS

The following public rooms are situated on decks with lift access:

- **Dining Room and Bar:** Located on Sturt Deck
- **Paddlewheel Lounge:** Situated at the stern of the vessel over two levels. The lower lounge is situated on Randell Deck and includes gift shop and café and the upper lounge is situated on Cadell Deck

The following public rooms are situated on decks without lift access:

- **Laundry and Gym:** Located on Chaffey Deck and are only accessible by stairwells
- **Sun deck:** Located on the upper deck and is only accessible by a steep shallow set of stairs

### PASSENGER CABINS

Passenger cabins are located on Chaffey, Randell and Cadell Decks

- Cadell Deck cabins are most suitable for passengers with limited mobility

- All cabins open outward, so care must be taken walking around the decks
- All cabins except the Disabled Outside Cabins (Randell 10 and 11; Cadell 59 and 60) have one step up into the bathroom and one step over the shower tray to enter the shower
- Chaffey Deck inside cabins are only accessible by stairwells and there is no lift access to this deck
- Randell Deck cabins have one step outside and one step inside to enter the cabin
- There are no steps into cabins for Chaffey and Cadell Decks

### DISABLED CABINS

The Murray Princess has four cabins specially designed for wheelchairs. Two cabins feature twin beds and two feature a double bed and a single bed.

Special Features:

- Wheelchair access doors and bathrooms
- Continuous level bathrooms
- Telephone contact with 24hr emergency numbers
- Handrails
- Hand held shower
- 2 mirrors in bathroom – one at normal height, one at wheelchair height
- All cabins have shower chairs and other equipment is available on request
- Height of beds 60cm from floor to top of mattress to enable passengers to slide off chair onto the bed with no difficulty.

### WATER ACTIVITIES and GETTING ASHORE

The Murray Princess has a tender boat for speedboat rides. Passengers are required to 'climb' directly into the tender from the Murray Princess. The deck crew are always on hand to assist and to help passengers with life jackets.

During the course of the cruise Murray Princess stops at a number of riverside locations where passengers can go ashore via the gangway. The steepness of the gangway will vary depending on the location (varying from steep riverbanks to flat historic wharves). The crew are always on hand to assist passengers ashore. The terrain will also vary depending on river conditions. Rough ground, inclines and sand may provide obstacles to those with limited mobility. Wheelchair access for onshore tours may not be possible.



ADELAIDE COACH TRANSFER MAP



**COACH TRANSFERS**

**Bookings are essential.** Complimentary Adelaide coach transfers to Mannum will depart and return from the following locations:

<b>Adelaide Central Bus Station</b> .....	85 Franklin Street, Adelaide .....	Pick-up at 1.20pm
<b>Hilton Adelaide</b> .....	233 Victoria Square, Adelaide .....	Pick-up at 1.30pm
<b>Majestic Roof Garden Hotel</b> .....	55 Frome Street, Adelaide .....	Pick-up at 1.35pm
<b>Crowne Plaza Adelaide</b> .....	27 Frome Street, Adelaide .....	Pick-up at 1.35pm
<b>Stamford Plaza Adelaide</b> .....	50 North Terrace, Adelaide .....	Pick-up at 1.45pm
<b>The Terrace Hotel Adelaide</b> .....	208 South Terrace, Adelaide .....	Pick-up at 2.00pm

The return arrival time to Adelaide on Monday and Friday is approximately 11.00am to 11.30am, or approximately 12.00pm at Adelaide Airport – pre-bookings are essential.

**PRIVATE CAR TRANSFERS**

Additional charges apply and pre-bookings are essential. Private car transfers are available to/from the Adelaide CBD as well as a return to Adelaide Airport. Please call 1300 729 938 for private transfer prices and bookings.



**ADELAIDE TO MANNUM DIRECTIONS**

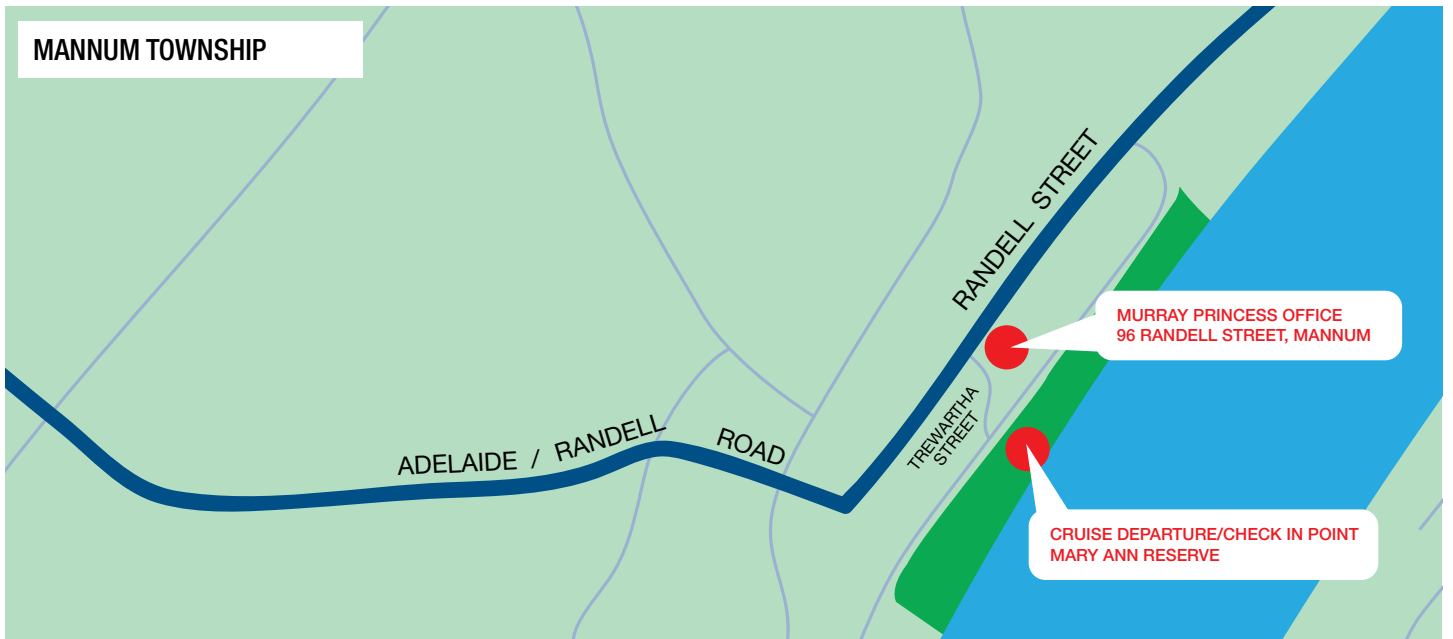

**SELF-DRIVE DIRECTIONS FROM ADELAIDE CBD TO MANNUM. PLEASE ALLOW 1.5 HOURS TRAVEL TIME.**

Travel on the South Eastern Freeway (National Highway M1) and take the Monarto Turnoff. Follow the signs to Mannum. When you arrive into Mannum, turn off Randell Street into Trewartha Street to Mary Ann Reserve. Park your vehicle in the carpark in Mary Ann Reserve and proceed to check in on board the Murray Princess. Boarding commences from 2.30pm. Please ensure you are at the vessel no later than 4.00pm. These times apply for all cruises unless stated. For Special Event Cruises, please refer to your itinerary for boarding times. Once on board, the crew will assist you with your luggage and take it to your cabin. You will be instructed by the crew where to park your vehicle for the duration of your cruise.

**MANNUM CAR PARKING**

Complimentary car parking is available at Mannum and is subject to availability – pre-bookings are essential. Our facilities do not cater for caravans or motorhomes.

DECK PLAN

SUN DECK

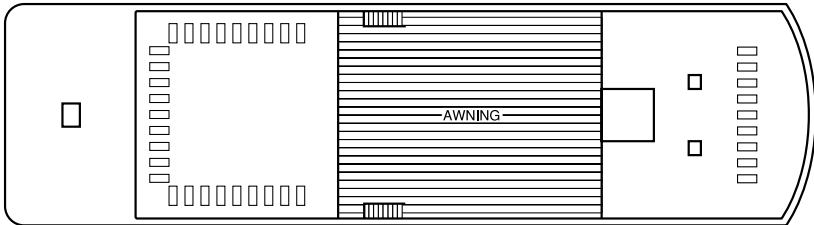

STURT DECK

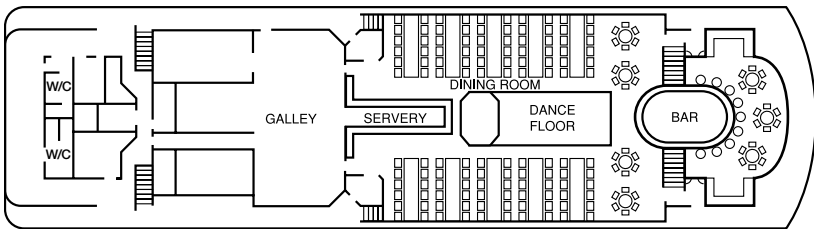

CADELL DECK

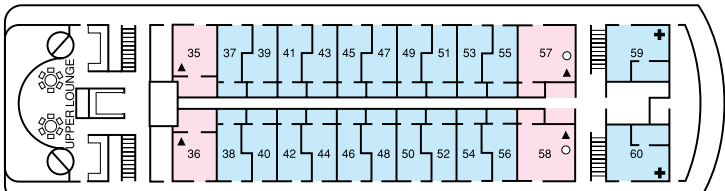

RANDELL DECK

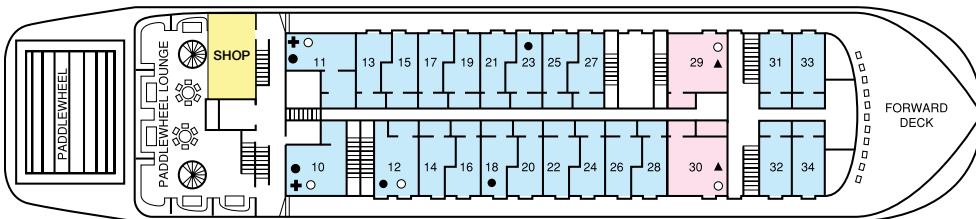

CHAFFEY DECK

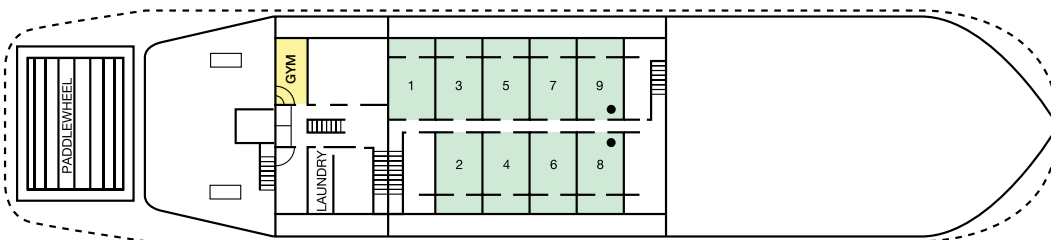

LEGEND

- STATEROOM
- OUTSIDE CABIN
- INSIDE CABIN

All rooms have twin beds unless indicated as follows:

- EXTRA BED
- DOUBLE BED
- + DISABLED FACILITIES



ACCOMMODATION

**ACCOMMODATION**

The Murray Princess has 60 cabins and staterooms each with private bathroom ensuite, electric blankets, soap, shampoo, towels, hairdryers and daily servicing. Each cabin is approximately 12sq metres. Four of the outside cabins and their ensuite bathrooms are wheelchair accessible. Two cabins located on Randell Deck are opposite the lift for easy access to the dining and lounge decks.



**Stateroom (6)**

Our spacious Staterooms are located on the Randell and Cadell decks. Each stateroom offers a queen bed (some have an extra single bed) and open onto the outside deck walkway. Mini-bars, fridges and tea and coffee making facilities are also included.

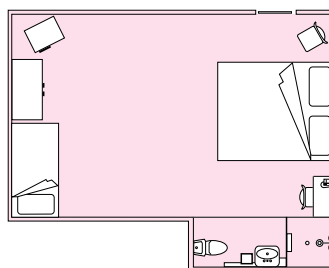

**Outside Cabin (45)**

Outside cabins are located on Randell and Cadell Decks and the majority of these cabins have twin bedding with limited double bedded cabins available. Each outside cabin opens onto the outside deck walkway with picture windows to view the passing scenery.

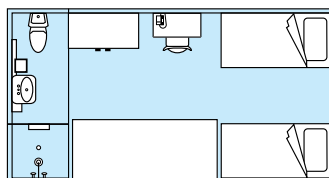

**Inside Cabin (9)**

Inside cabins are located on the lower Chaffey Deck and open onto a wide inside passageway. Inside cabins offer twin bedding with limited double bedded cabins available and have portholes facing the outside. Inside Cabins are accessed via stairs, there is no lift access to this deck.

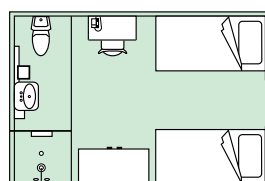



MEDICAL EMERGENCIES & SERVICES

There is no doctor or pharmacy on-board the vessel, however our Officers are trained in First Aid. Please ensure you bring any prescription medicines you may require.

All medical and transport services are at the passenger's expense. Please contact your Travel Insurance provider for insurance claims.

**MEDICAL EMERGENCIES**

In a medical emergency, please immediately tell a crew member. If you cannot locate a crew member, an emergency telephone is located next to the Port Aft door to the Paddlewheel Lounge on the Randell Deck. Please use this telephone only in an emergency and your call will be directed to a crew member. The Murray Princess crew will contact ambulance services in life threatening situations.

**MEDICAL SERVICES**

The nearest Medical Centre and/or Pharmacy is located at Mannum. There are no public transport facilities available, transport is only available via taxi cab.

The following is a guide only of taxi cab charges:

- Blanchetown to Mannum \$270
- Swan Reach to Mannum \$190
- Walker Flat to Mannum \$100
- Mannum to Adelaide \$270

Please note, due to the long distances involved, taxi companies may require a credit card pre-payment.

**YOUR RESPONSIBILITIES**

Your attention is drawn to Clauses 9b, 9e and 9f of the Passenger Cruise Contract.

- 9(b) Consent to treatment. If, in the opinion of the Carrier, a passenger is in need of medical assistance and is unable to request it, the passenger hereby consents to the Carrier making such medical arrangements as it deems necessary, at the cost of the passenger.
- 9(e) Refusal of passage. The Carrier reserves the right to refuse passage to a passenger who has failed to give proper notice of physical disability, illness or handicap requiring special care, attention or treatment or who in the Carrier's opinion is physically or mentally unfit for travel. In such event the fare will be refunded at the sole discretion of the Carrier, and the Carrier shall be entitled to deduct any expenses associated therewith.
- 9(f) Treatment at passenger's risk. Subject to the foregoing, any medicines, surgical attendance or medical treatment furnished by a qualified Doctor or Medical service personnel (all of whom are engaged as independent contractors) designated by the Carrier or the ship's officers or other servants of the Carrier, shall be and are accepted at the passenger's sole risk, and the Carrier shall not be responsible for the quality, nature or consequence thereof.



OPTIONAL ONSHORE TOURS

**Murray Princess offers these optional tours during and after your cruise. Please note tours are operated by outside contractors and subsequently tour prices and details are subject to change without notice. Please refer to our website for current pricing of all optional onshore tours.**

**MONARTO SAFARI PARK WILDLIFE TOUR**

Available on the 3 Night Discovery Cruise and the 7 Night Murraylands and Wildlife Cruise.

On arrival at Murray Bridge on Saturday (from 9:00am) the Wild Awaits and a coach will transfer you to Monarto Safari Park. Explore one of the world's largest open-range Safari Park experiences outside of Africa on an unforgettable guided tour from the luxury of your coach.

Monarto Safari Park spans more than 1500 hectares and is home to many exotic and native animals including Cheetah, Hyena, Painted Dogs, Giraffe, Zebra, Black and White Rhino, Deer, Antelope, Bison, Mongolian Horse and Australia's largest lion pride to name but a few.

After the tour, you will have some free time in the new Visitor Centre, gift shop, lookout and café before returning to Murray Bridge to re-board the Murray Princess in time for lunch at 11:25am.

**Inclusions:**

- Return luxury coach transfers from Murray Bridge to Monarto Safari Park.
- 1 hour 15 minute fully guided Safari tour of Monarto Safari Park onboard your luxury coach - marvel at the many exotic and native animals which call our expansive open grasslands home
- Free time to explore the Visitor Centre, gift shop, lookout/ exhibition area and cafe.

Departs at 9:00am on selected Saturdays from Murray Bridge and returns to Murray Bridge at 11:25am.

**Please note: The wearing of face masks is mandatory on buses at Monarto Safari Park for all visitors 12 years and older (except for those with exemptions or health conditions).**

Seats are limited on this tour and pre-booking are essential. Please call 1300 729 938 for bookings.



**NOCTURNAL TOUR AT SUNNYDALE**

Enjoy a real Australian wildlife experience as your hosts take you spotlighting on the remnants of the old Sunnydale station. A unique experience in comfortable, purpose-built cart will give you the opportunity to view kangaroos, wombats, foxes, bats and owls, or just view the starlit skies as you meander through the bush. Special stops along the way are included to view the spectacular night sky which is part of the River Murray International Dark Sky Reserve. Blankets, commentary and the antics of the two farm dogs make it an enjoyable experience.

Departs after dinner on selected Wednesday evenings.

**BUSH TUCKER BREAKFAST AT SUNNYDALE**

For that special experience Murray Princess passengers can enjoy bush tucker, combined with a traditional breakfast on the shores of the Murray River wetlands at Big Bend.

Your hosts will collect you from Murray Princess and transport you to the bush kitchen for a 3 course breakfast. Savour the taste of kangaroo sausages, scrambled eggs flavoured with bush tomato spice and saltbush, oven baked tomato lightly dressed with mountain pepper and freshly picked samphire and mushrooms garnished with desert flakes. Double smoked bacon, kutjera relish and salt with attitude followed by wattleseed toast with wild lime marmalade, lemon myrtle butter and quandong jam. All finished off with wattleseed pancakes and real billy tea. The early morning sounds of the river and its birdlife create a peaceful ambience for the start of your day, topped off with a welcome glass of bubbles.

Departs at 8am on selected Thursday mornings.

Gluten Free meal options available. Please advise when you make your booking on board.

The above 2 onshore experiences can be booked on board through your Guest Services Attendant and are available on the 4 Night Outback Heritage Cruise, 7 Night Murraylands and Wildlife Cruise and the 7 Night Upper Murraylands Cruise.

OPTIONAL ONSHORE TOURS

**BAROSSA WINE AND HERITAGE TOUR**

Available on the 3 Night Discovery Cruise, 4 Night Outback Heritage Cruise and the 7 night Murraylands and Wildlife Cruise (not available on the conclusion of the 7 Night Upper Murraylands Cruise).

Depart Mannum, and travel into the famous Barossa, Australia's richest and best-known wine making region.

Your first stop is at **Jacob's Creek Visitor Centre**, where you will enjoy a light morning tea while taking in the breath-taking views over the vineyards. You will have the opportunity to participate in a structured wine tasting before departing and heading to Lambert Estate in Angaston for lunch.

Enjoy a two-course lunch at **Lambert Estate**, incorporating fresh regional produce available in season. Pair this with a glass of wine (own cost) and take in the magnificent outlook from the deck of this popular vineyard.

The next stop is a visit to Maggie Beer's Farm Shop, an absolute must whilst visiting the Barossa. Learn about Maggie Beer - the cook, writer and founder of 'Maggie Beer Products'. Browse amongst the wonderful selection of seasonal produce, with the option to purchase her products or her signed books.

Alternatively, you may prefer to simply sit back and take in the incredible views over the lake.

Following Maggie Beer's, you'll make your way by coach through the picturesque regions of **Seppeltsfield** and **Marananga** which is home to many iconic cellar doors. No trip to the Barossa is complete without visiting Seppeltsfield Road which is full of history and lined with distinctive palm trees.

Sit back, relax and enjoy the scenery as you travel back through the picturesque **Eden Valley**. View the Murrayland flats from atop Palmer hill as you descend down into Mannum where you will re-board the Murray Princess, or transfer to a luxury coach for your journey back to Adelaide.

**Please note:** Itinerary is subject to change without notice.

Departs at 9:30am on selected Mondays/Fridays from Mannum and concludes 5:30pm Mondays/Fridays in Adelaide or approximately 6:00pm at Adelaide Airport.

Seats are limited on this tour and pre-booking are essential. Please call 1300 729 938 for tour prices and bookings.

Please refer to our website for current pricing of all optional onshore tours.

